



Reliance Worldwide Corporation reserves the right to modify designs and specifications and to withdraw and introduce products at any time without notice.

Installation is subject to the requirements of the applicable regulatory authority, the National Construction Code Volume Three – Plumbing Code of Australia, associated reference standards as applicable at the time and AS/NZS 3500. For further Scope of Use, please visit [www.rmc.com.au/resources](http://www.rmc.com.au/resources).

Reliance Worldwide Corporation (Aust.) Pty. Ltd. (RWC) will either replace or repair any defective goods where the defect arose as a result of manufacture within the warranty period. You may contact RWC at the phone number, address or e-mail shown and will be required to return the goods for evaluation. Should the defect be found to be one of our manufacture we will send you a replacement product to your stated address at our expense. Our goods come with guarantees that cannot be excluded under Australian Consumer Law. You are entitled to a replacement or refund for a major failure and for compensation for any other reasonably foreseeable loss or damage. You are also entitled to have the goods repaired or replaced if the goods fail to be of acceptable quality and failure does not amount to a major failure.

® = Registered Trade Mark of Reliance Worldwide Corporation

© 2025 All rights reserved

IS1151 REV-

# Installation Instructions



INSTALLATION AND MAINTENANCE SHOULD ONLY BE UNDERTAKEN BY COMPETENT PERSONNEL.

THE PACKING IS PROVIDED TO PROTECT THE VALVE DURING TRANSPORT, PLEASE DO NOT INSTALL THE VALVE IF DAMAGE IS EVIDENT.

☎ 1800 810 803

🌐 [rmc.com.au](http://rmc.com.au)

✉ [sales.au@rwc.com](mailto:sales.au@rwc.com)

☎ 1800 062 669

27-28 Chapman Place, Eagle Farm QLD 4009, Australia



RMC Reliance Valves is a division of  
Reliance Worldwide Corporation (Aust.) Pty. Ltd.  
ABN 71 004 784 301

**PRX1504, PRX2004, PRV2504,  
PRX3204, PRX3205, PRX4004,  
PRX4005, PRX5004, PRX5005**

PRESSURE REDUCING VALVE FOR  
NOMINAL SIZE:

**DN15, DN20, DN25,  
DN32, D40, DN50**



## Installation Instructions

The RMC Series Adjustable Pressure reducing valves comply with Australian Standards AS1357.2 and AS/NZS 4020 and reduces a high inlet pressure to a lower delivery pressure in installations and devices.

## Design

<b>Inlet Pressure</b>	Max. 2000kPa
<b>Outlet Pressure</b>	Adjustable 155-550kPa Factory set to 500kPa
<b>Outlet Pressure for PRX3205, PRX4005, PRX5005</b>	Adjustable 600-1000kPa Factory set to 800kPa
<b>Operating temperature</b>	Max. 80°C
<b>Mounting Position</b>	Any

### Fluids

Water, compressed air,  
neutral non adhesive fluids  
and gases.

## Installation

The pressure reducing valve is predominately used in the field of potable water installations. It is recommended that a filter be installed upstream to effectively protect the pressure reducing valve. Install the pressure reducing valve, ensuring the direction of flow matches the arrow on the valve body, without applying stresses.

## Operation

For setting the outlet pressure:

- Loosen the securing screw (1) in the knob (2).
- Twist the knob counter-clockwise to decrease the pressure down to it's minimum setting (3).
- Open a tap downstream of the pressure reducing valve to relieve the excess pressure for a couple of seconds.
- Twist the knob clockwise to increase the pressure to the desired setting.
- Re-tighten the securing screw in the knob.
- Fit the cap (4) to protect the pressure reducing valve against inadvertent adjustment.

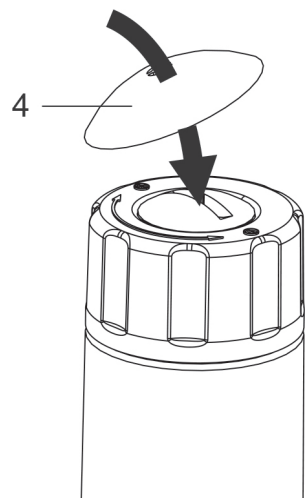
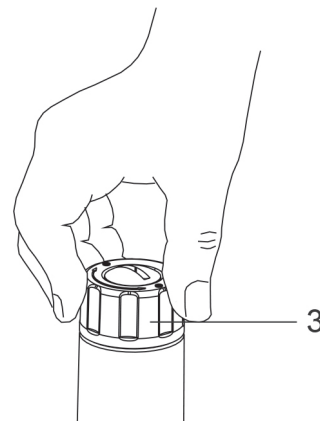
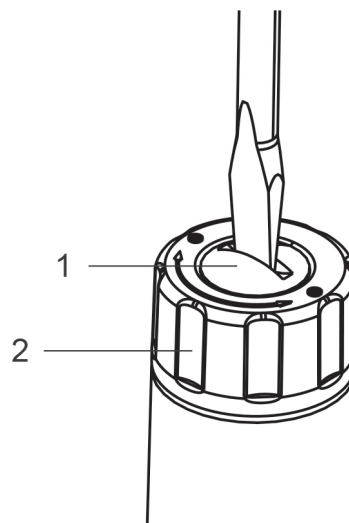

## Maintenance

Close the upstream and downstream isolating valves, (release downstream pressure before closing). Unscrew the captive nut (5) then remove the cartridge (6)

**Only use cold water for cleaning**

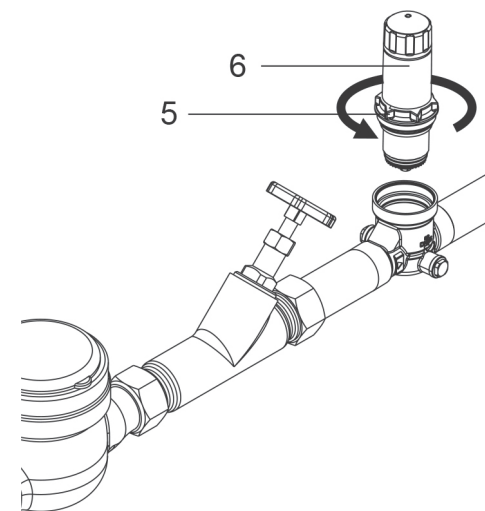

Re-insert the pressure reducing valve cartridge into the body and screw the cartridge into the valve body (7).

