

# Hose Connection Vacuum Breaker

## Scope of Use / Specification Sheet

The RMC Hose Connection Vacuum Breaker is designed to prevent back siphonage through a hose connected to a safe drinking water supply.



### Product List

#### Order Code Description

HCX01	20mm (¾") - Brass
HCX02	20mm (¾") - Chrome
HCX03	25mm (1") - Brass
HCX04	25mm (1") - Chrome

### Application

The Hose Connection Vacuum Breaker provides protection to the potable water supply from contamination in low hazard applications, such as flexible connections over domestic fixtures and external hose taps.

### Materials

Body	Lead free brass or chrome plated lead free brass
Spring	Stainless steel

### Features and Benefits

- Comprises a single check valve, spring loaded to closed position with atmospheric vacuum breaker vent
- Corrosion resistant
- Choice of brass or chrome plated finish
- Lead free brass body
- Suitable for hot or cold water service (up to 80°C at 1400kPa)
- Durable
- Maximum working pressure of 1400kPa
- 'Breakaway' set screw protects against tampering
- Approved to AS/NZS 2845.1

### Technical Specifications

Inlet	Female BSP
Outlet	Male BSP
Maximum working pressure	1400kPa
Maximum temperature	80°C

## Hose Connection Vacuum Breaker

### Dimensions

Model	Inlet/Outlet	A	B	C
HCX01 / HCX02	G $\frac{3}{4}$ "	34	34	38
HCX03 / HCX04	G1"	41	38	44

**Note:** All measurements in mm unless otherwise stated.

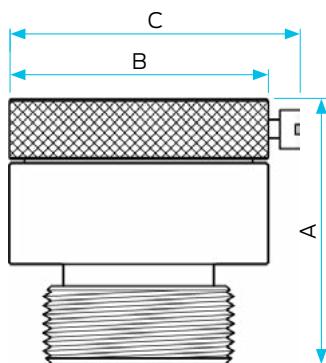

### Installation

Installation is subject to the requirements of the applicable regulatory authority, the National Construction Code Volume Three – Plumbing Code of Australia, associated reference standards as applicable at the time and AS/NZS 3500.1.

### Warranty

Reliance Worldwide Corporation (Aust.) Pty. Ltd. (RWC) will either replace or repair any defective goods where the defect arose as a result of manufacture within the warranty period. You may contact RWC at the phone number or e-mail shown below for further information or to make a claim.

Visit [www.rmc.com.au/warranty](http://www.rmc.com.au/warranty) to view the warranty statement in full and for further important information.

### Standards and Approvals



**Lead Free**

AS/NZS 2845.1  
WMKA1325