

V200 Water Meters

Scope of Use / Specification Sheet

The V200 meter is designed for the measurement of cold potable water offering outstanding accuracy, long-term maintenance free working life and is highly resistant to tampering.



WM216PD

WM328PD

Product List

Order Code	Description
WM206PD	20mm Meter Thread DCV - QUU
WM214PD	20mm Ball Joint DCV - Standard
WM215PD	20mm Meter Thread DCV - Standard
WM216PD	20mm Meter Thread DCV - Unity Water
WM217PD	20mm Meter Thread DCV - Standard - WA
WM260PD	25mm Meter Thread DCV - Standard
WM261PD	25mm Meter Thread DCV - QUU S/N
WM262PD	25mm Meter Thread DCV - Logan S/N
WM263PD	25mm Meter Thread DCV - UE S/N
WM325PD	32mm Meter Oval Flanged Standard
WM326PD	32mm Meter Oval Flanged - QUU S/N
WM327PD	32mm Meter Oval Flanged - Logan S/N
WM328PD	32mm Meter Oval Flanged - Unity Wat S/N
WM405PD	40mm Meter Oval Flanged - Standard
WM406PD	40mm Meter Oval Flanged - Logan S/N
WM407PD	40mm Meter Oval Flanged - Unity Wat S/N

Materials

All V200 meters are manufactured from the highest quality materials ensuring maximum resistance to wear and corrosion. Copper alloys in contact with potable water are dezincification resistant and comply with the Australian Standard AS 2345.

All other materials in contact with potable water comply with the Australian Standard AS/NZS 4020.

Features and Benefits

- Positive displacement volumetric principal of measurement ensures registration even at the very lowest rates of flow with maintained accuracy over the flow range
- Volumetric rotary piston design permits optimum performance in horizontal, vertical or inclined pipelines without affecting accuracy
- Requires no calibration throughout its lifespan
- e^{sens} Inductive register for improved output performance and security. The register can be rotated 359°
- Optional bi-directional, two channel pulse transmitter can be fitted to the inductive register
- Use of advanced engineered plastics for the measuring chamber minimises wear and maintains reliability under all operating conditions
- O-Ring sealing ensures that internal leaks that could by-pass the measuring chamber are eliminated
- A leak indicator is fitted as standard
- 20mm and 25mm meters can be supplied with various standard connections (e.g. nut and tail, ball joint, etc.)
- 32mm and 40mm meters have oval flanged connections

Warranty

Reliance Worldwide Corporation (Aust.) Pty. Ltd. (RWC) will either replace or repair any defective goods where the defect arose as a result of manufacture within the warranty period. You may contact RWC at the phone number or e-mail shown below for further information or to make a claim.

Visit www.rmc.com.au/warranty to view the warranty statement in full and for further important information.

V200

Water Meters

Performance Specifications

Nominal Meter Diameter (DN MM) - STD Q_3/Q_1 Ratio		UNITS	DN20 - 315	DN25 - 315	DN32 - 250	DN40 - 20
Minimum Flow Rate	$Q_1 \pm 5\%$	L/h	12.7	20	40	80
Transitional Flow Rate	$Q_2 \pm 2\%$	L/h	20.32	32	64	128
Permanent Flow Rate	$Q_3 \pm 2\%$	kL/h	4	6.3	10	16
Overload Flow Rate	$Q_4 \pm 2\%$	kL/h	5	7.875	12.55	20
Minimum Registration Flow Rate		L/h	< 1	< 1	< 1	< 1
Pressure Loss with DCV/RFR		kPa	65	67.7	22.5	17.8
@ Flow Rate to AS 3565		L/h	2500	3500	5000	7500
Maximum Working Pressure		kPa	1600	1600	1600	1600
Maximum Admissible Temperature		°C	30	30	30	30
Limiting Temperature		°C	50	50	50	50
Minimum Counter Registration		Litre	0.02	0.02	0.02	0.02
Maximum Counter Registration		kL	99999.9999	99999.9999	99999.9999	99999.9999
Standard Pulse Output / (optional)		Litres/pulse	1 / (10)	1 / (10)	1 / (10)	1 / (10)
NMI Pattern Approval Certificate		Number:	14/3/1	14/3/11	14/3/12	14/3/18
Watermark Approval		Number:	WM040243			

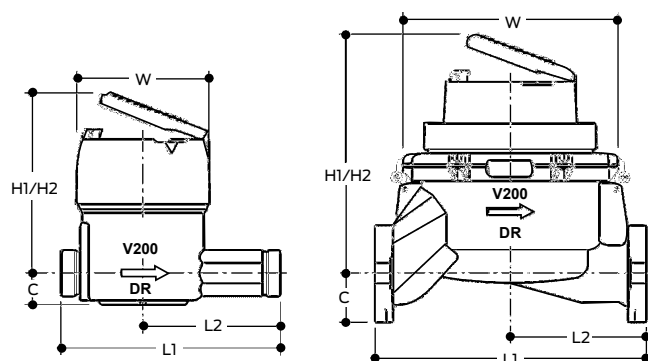

Standard and Approval



Dimensions

Nominal Diameter (DN MM)	UNITS	DN20	DN25	DN32	DN40
Meter Lengths (L1 / L2)	mm	154 / 96.3	178 / 89	190 / 95	232 / 145
Centreline Height (C)	mm	21.0	25.0	34.0	39.0
Maximum Width (W)	mm	94.0	121.0	151.0	181.0
Meter Height - Lid closed / open (H1 / H2)	mm	102 / 167	130 / 200	146 / 216	166 / 236
Bare Meter Weight*	kg	1.25	2.02	4.64	6.8

* Weight shown is unpacked without connections and is approximate only.