

# Water Saving Aerators

## Scope of Use / Specification Sheet

Water saving aerators and inserts can be easily fitted to any new or existing tap with an aerated outlet. The aerator will reduce the amount of water flowing from the outlet without adversely affecting outlet pressure.



### Product Code

Model	Reduced Flow	Quantity	Product Code
<b>Female Chrome Aerators</b>			
AFJ02C	2 l/min	10 pack	AFJ02C.10
AFL05C	5 l/min	10 pack	AFL05C.10
AFL08C	8 l/min	1 pack	AFL08C.01
		10 pack	AFL08C.10
<b>Male Chrome Aerators</b>			
AMJ02C	2 l/min	10 pack	AMJ02C.10
AML05C	5 l/min	10 pack	AML05C.10
AML08C	8 l/min	1 pack	AML08C.01
		10 pack	AML08C.10
<b>Aerator Inserts</b>			
AIJ02	2 l/min	1 pack	AIJ02.01
		10 pack	AIJ02.10
AIL05	5 l/min	1 pack	AIL05.01
		10 pack	AIL05.10
AIL08	8 l/min	1 pack	AIL08.01
		10 pack	AIL08.10

### Features and Benefits

- Available in 2, 5 and 8 litres per minute flow capacities
- Easily retrofitted to existing fittings and fixtures
- Reduce water usage by up to 75%
- No discernible affect on output flow or pressure
- Jet spray pattern standard for 2 litre per minute low flow insert

### Installation

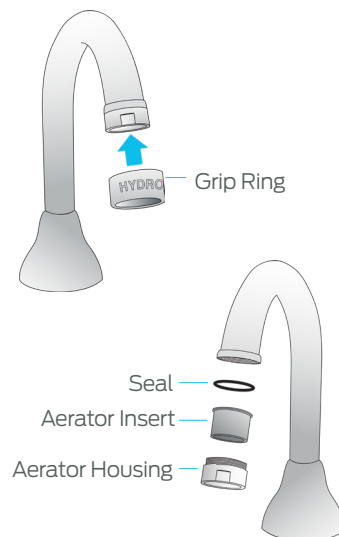

#### Sink

- Slip the HydroSave grip ring over the aerator housing
- Unscrew the existing aerator housing
- Remove the old aerator insert making sure you also remove the old seal
- Place the new HydroSave Aerator Insert into the housing and place the new seal on top of the aerator
- Screw the aerator housing back into the spout and tighten using the HydroSave grip ring

### Description

On average, 22 litres of water flows from a household tap every minute. HydroSave Water Saving Aerators and Inserts are designed to reduce outlet flow 2, 5 or 8 litres per minute, which is a saving of up to 90% depending on the application.

Flow from 2 litre per minute aerators is provided in a jet spray, which is ideal for use in applications requiring low volume. All other flow rates are provided in a standard aerated flow.

## Water Saving Aerators

### Technical Specifications

Maximum Temperature 65°C

### Application

HydroSave Water Saving Aerators and Inserts are designed for use in all domestic and commercial applications. The Inserts are designed to be easily fitted to almost any new or existing tapware with an aerated outlet.

### Installation Requirements

Installation is subject to the requirements of the applicable regulatory authority, the National Construction Code Volume Three – Plumbing Code of Australia, associated reference standards as applicable at the time and AS/NZS 3500.1.

### Warranty

Reliance Worldwide Corporation (Aust.) Pty. Ltd. (RWC) will either replace or repair any defective goods where the defect arose as a result of manufacture within the warranty period. You may contact RWC at the phone number, address or e-mail shown below for further information or to make a claim.

Visit [www.rmc.com.au/warranty](http://www.rmc.com.au/warranty) to view the warranty statement in full and for further important information.

### Materials

Aerator	Acetal Co Polymer
O-Ring	EPDM
Housing	DR Brass chrome plated to AS 3688

### Standards and Approvals



#### Model

- AFJ02C
- AMJ02C
- AIJ02

#### Model

- AFL05C
- AML05C
- AIL05

#### Model

- AFL08C
- AML08C
- AIL08



AS 5200.0372  
WMKA21177