

# Water Saving Kit

## Scope of Use / Specification Sheet

Everything that you need to make instant water savings.



### Product Code

Model	Product Code
Water Saving Kit	CHK.01

### Description

The water saving kit gives you everything that you need to make instant water savings in the average home and achieve up to a 6 star water saving rating.

#### The kit includes:

- 2 x IL09C Inline Flow Controllers (9 l/min) for shower outlets
- 2 x AIL08 Aerator Inserts (8 l/min) for aerated kitchen and laundry sink outlets
- 1 x AIL05 Aerator Insert (5 l/min) for basin outlets
- 1 x AIJ02 Aerator Insert (2 l/min) for basin outlets

### Features and Benefits

- Quick and easy to install
- Everything needed for the average home in one simple kit
- Comprehensive instructions provided with the kit
- Additional aerators and flow controllers readily available from the Hydrosave range

### Installation

Instructions are provided with the kit which detail the installation of each of the water saving devices provided in the kit.

#### Shower

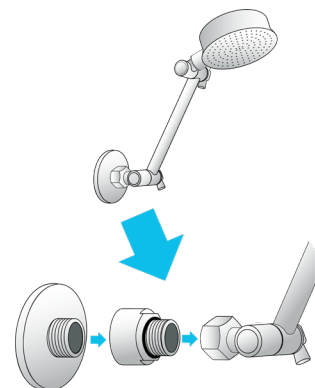

- 1 Unscrew the existing shower head by turning it anti-clockwise
- 2 Screw the HydroSave Inline Flow Controller onto the wall outlet
- 3 Screw the shower head onto the HydroSave Inline Flow Controller ensuring it seals against the O-Ring
- 4 Turn the shower on and check the connections for leaks and tighten if necessary

#### Sink

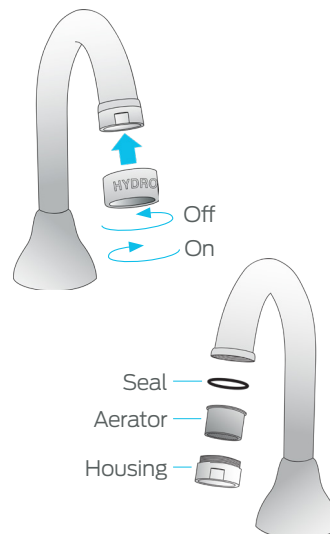

- 1 Slip the HydroSave grip ring over the aerator housing
- 2 Unscrew the existing aerator housing
- 3 Remove the old aerator insert making sure you also remove the old seal
- 4 Place the new HydroSave Aerator Insert into the housing and place the new seal on top of the aerator
- 5 Screw the aerator housing back into the spout by turning it anti-clockwise and tighten using the HydroSave grip ring

## Water Saving Kit

### Technical Specifications

Maximum Temperature	65°C
Minimum Pressure	105kPa
Maximum Pressure	1034kPa

### Operation

Under low flow conditions the O-Ring remains relaxed and provides a fixed orifice. As flow increases the O-Ring reacts against the flow by unseating and slowly reducing the flow capacity of the orifice until the maximum restriction is achieved.

#### Low Flow

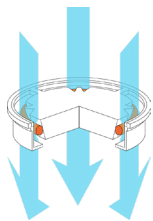

O-Ring in relaxed state. Flow controlled by orifice size only.

#### Moderate Flow

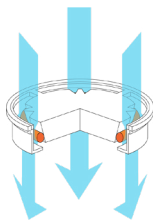

O-Ring partially unseated causing partial restriction to flow.

#### High Flow

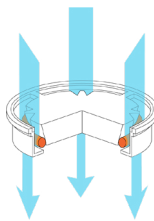

O-Ring fully unseated causing maximum restriction to flow.

### Installation Requirements

Installation is subject to the requirements of the applicable regulatory authority, the National Construction Code Volume Three – Plumbing Code of Australia, associated reference standards as applicable at the time and AS/NZS 3500.1.

### Warranty

Reliance Worldwide Corporation (Aust.) Pty. Ltd. (RWC) will either replace or repair any defective goods where the defect arose as a result of manufacture within the warranty period. You may contact RWC at the phone number, address or e-mail shown below for further information or to make a claim.

Visit [www.rmc.com.au/warranty](http://www.rmc.com.au/warranty) to view the warranty statement in full and for further important information.

### Materials

Aerator Insert Body	Acetal Co Polymer
Inline Flow Controller Body	DR Brass chrome plated to AS 3688
Inline Flow Controller Disc	Acetal Co Polymer
O-Ring	EPDM

### Standards and Approvals



#### Model

- AIJ02



#### Model

- AIL05



#### Model

- AIL08



#### Model

- IL09C

