

The Monotronic 2 Electronic Touch Free Hand Washing System incorporates an infrared sensor and a solenoid valve that automatically controls water supply to the tap as required.

Model	Catalogue Number
Monotronic 2 Touch Free Tap	7617N

Description

This valve is controlled by an infrared sensor that is built into the base of the spout supplied with the unit. The solenoid is powered by a 6V DC long life lithium battery. A Y-strainer is supplied with the unit and must be installed in the water line upstream of the solenoid valve. Isolation valves (not supplied) must be installed.

Application

The Monotronic 2 Electronic Hands Free Tap is ideal for use in hotels, airports, restaurants, sports complexes, clubs, theatres, food preparation areas and childcare centres. When hands are placed under the outlet sensor, the solenoid valve opens, allowing water to flow for a maximum of 60 seconds. Water flow stops once hands are removed from under the sensor.

Materials

Item	Dimensions (mm)	Comment
Solenoid Valve	62 x 72 x 38	Soft closing
Waterproof 6V Battery Case	70 x 63 x 35	6V DC long life lithium battery
Sensor	∅ 56 x 25 H Lead 750mm	Chrome
Y-Strainer	67 x 54 x 30	Brass
Outlet	196 x 120	Chrome

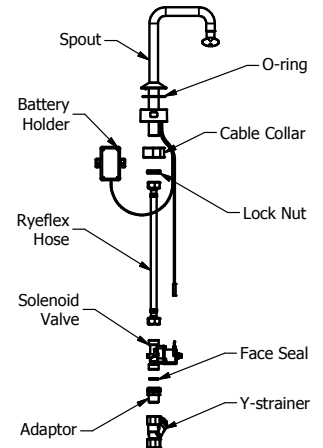

Features and Benefits

- Permits hygienic, hand free washing
- Helps prevent the spread of infectious diseases
- Saves water
- Can be used in conjunction with a thermostatic mixing valve or tempering valve
- Approved to WELS and AS/NZS 3718
- 6V DC long life lithium battery
- Microprocessor control
- In use LED indicator
- Water flow shuts down after 1 second should sensor be obstructed

Product Specifications

Water pressure range	150 to 1000kPa
Water temperature	For safety reasons water temperature should not exceed 40°C
Water control	15mm solenoid valve, normally closed
Sensing	Infrared sensor, active
Power adaptor	6V DC long life lithium battery
Approvals	WELS and Watermark AS/NZS 3718

Notes

The Monotronic 2 infrared sensor hand washing system shall be installed in accordance with the manufacturer's instructions. The system should only operate with a 6V DC long life lithium battery.



AS3718 WMKA 02001



Uniquely Australian



In accordance with AS/NZS 6400
Licence No. 0161
Reliance Worldwide Corporation
(Aust.) Pty. Ltd. ABN 71 004 784 301